

05-3100 Removing and installing chain tensioner

Preceding work:
Warning instructions when hood open (01-0085).

Operation no. of operation texts and work units or standard texts
and flat rates
05-7800, 05-7801

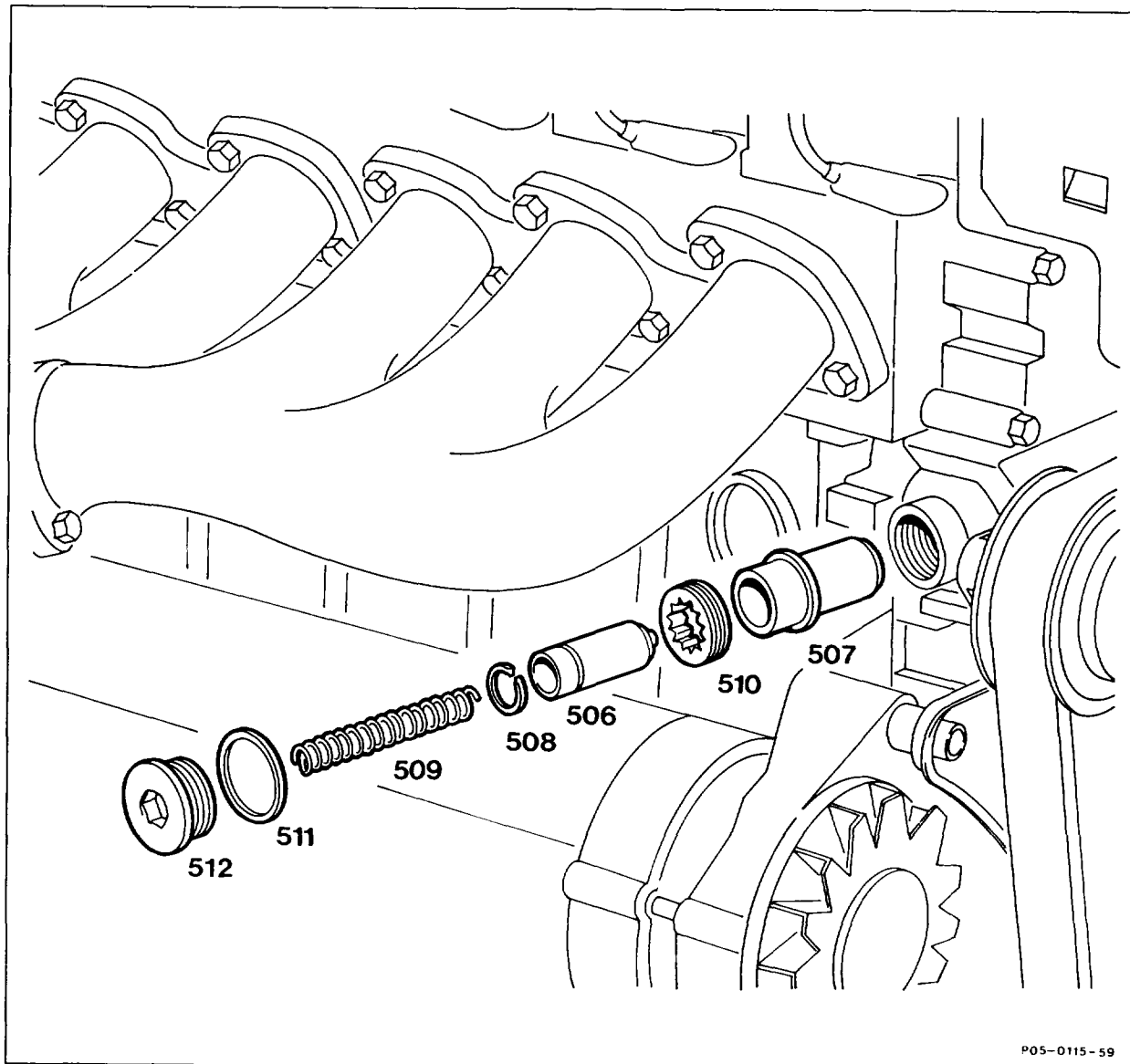

P05-0115-59

- | | |
|---|---|
| Screw plug (512) with seal (511) and compression spring (509) | unscrew, take out (step 1). |
| Threaded ring (510) | unscrew (step 2). |
| Chain tensioner housing (507) with pressure pin (506) | withdraw (step 3). |
| Pressure pin (506) with detent spring (508) | press out of chain tensioner housing (507) in direction of pressure (step 4). |

Chain tensioner housing (507)	insert into mounting hole (step 5).
Threaded ring (510)	screw in, tighten, 30 Nm (step 6).
Pressure pin (506) with detent spring (508) and compression spring (509)	insert (step 7).
Screw plug (512)	screw in, tighten, 50 Nm. Renew seal (511) (step 8).
Leaktightness	check.

Special tool

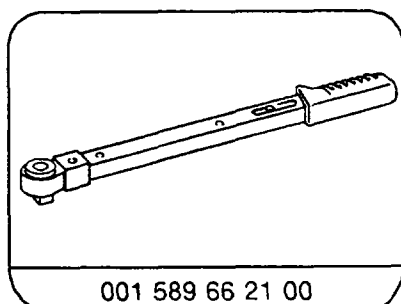

Commercial tools

Pin wrench insert 17 mm, 1/2" square	eg. Hazet, D-42857 Remscheid Order No. 985/17
Pin wrench insert 12 mm, 1/2" square	eg. Hazet, D-42857 Remscheid Order No. 985/12

Removal, installation

- 1 Unscrew plug (512) together with seal (511).
Take out compression spring (509).



The screw plug is pressurized by the compression spring.

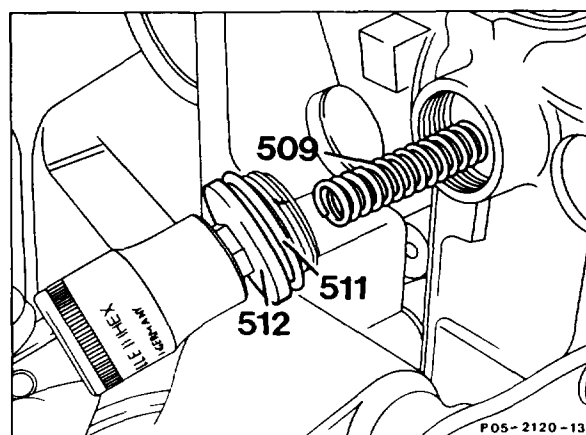

2 Unscrew threaded ring (510).

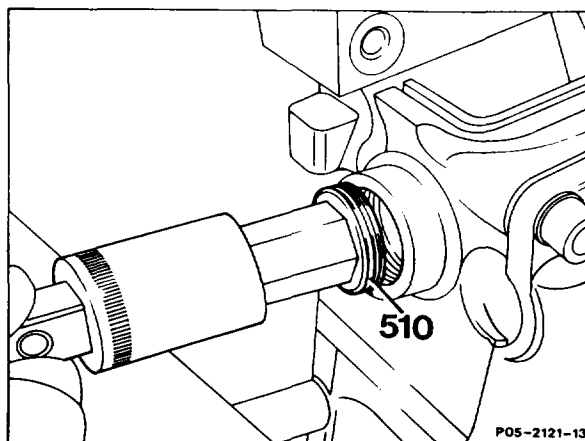

3 Withdraw chain tensioner, eg. with the aid of an M8 bolt (arrow).
The M8 bolt cannot be screwed in but should only be angled.

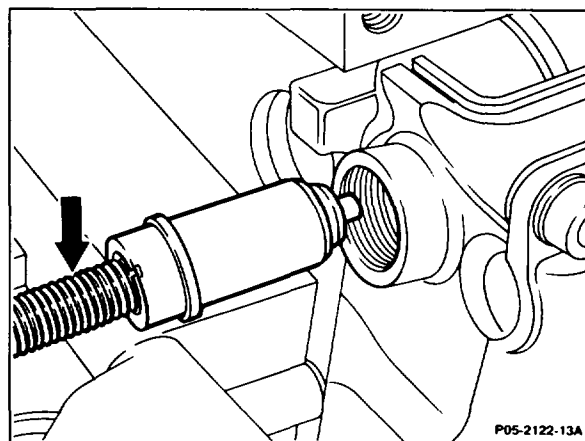

4 Chain tensioner must be disassembled before installing. This is done by pressing the pressure pin (506) with detent spring (508) out of the chain tensioner housing (507) in direction of arrow. Thoroughly clean all parts.

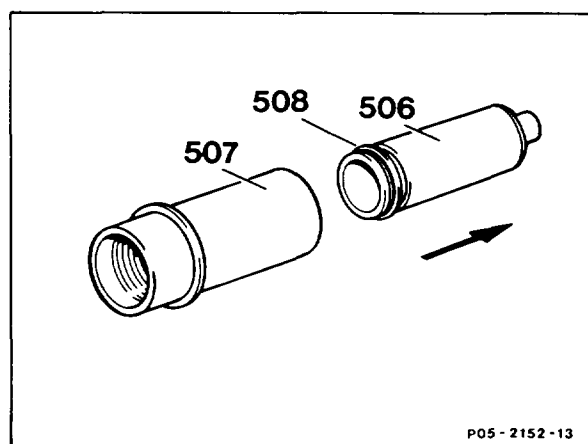

5 Insert chain tensioner housing (507) into mounting hole.

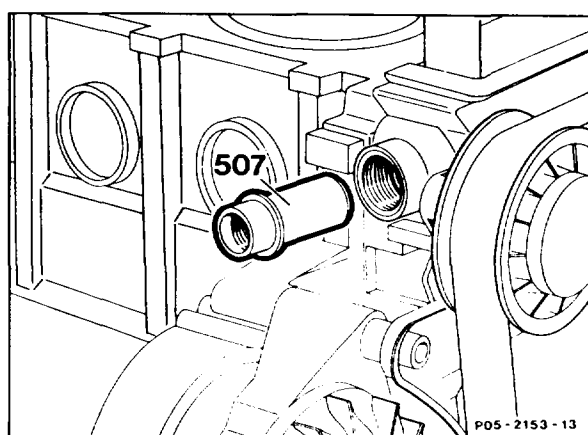

6 Screw in threaded ring (510), tightening torque 30 Nm.

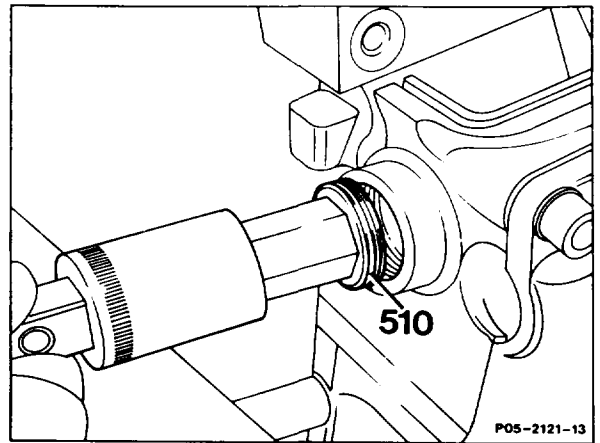

7 Insert pressure pin (506) with detent spring (508) into the assembled chain tensioner housing.

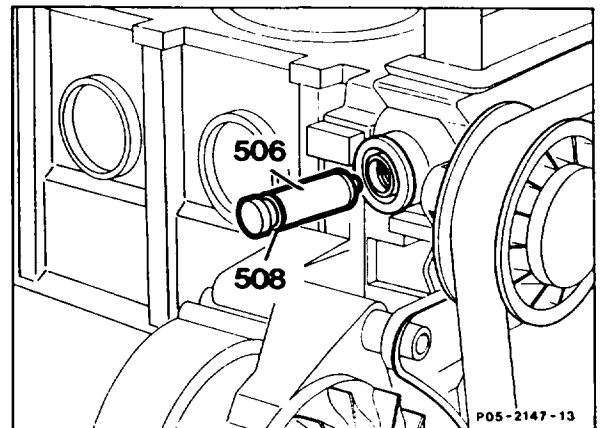

8 Install compression spring (509) and screw plug (512) with new seal (511). Tighten screw plug (512) to 50 Nm.

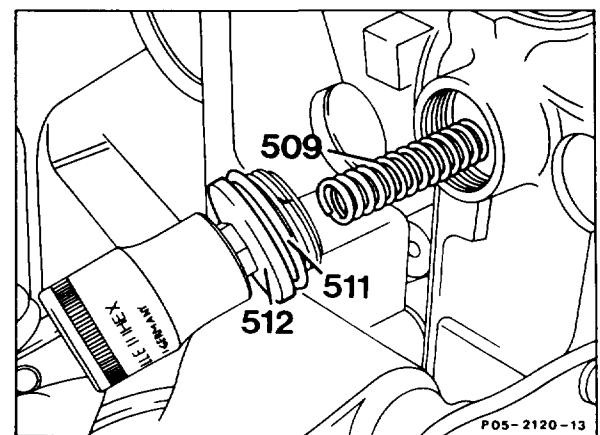

9 Run engine and check for signs of leaks.