

13-3420 Removing and installing poly-V-belt

Preceding work:
Viscous fan clutch removed (20-3120).

Operation no. of operation texts and work units or standard texts
and flat rates
13-1202 - 13-4001

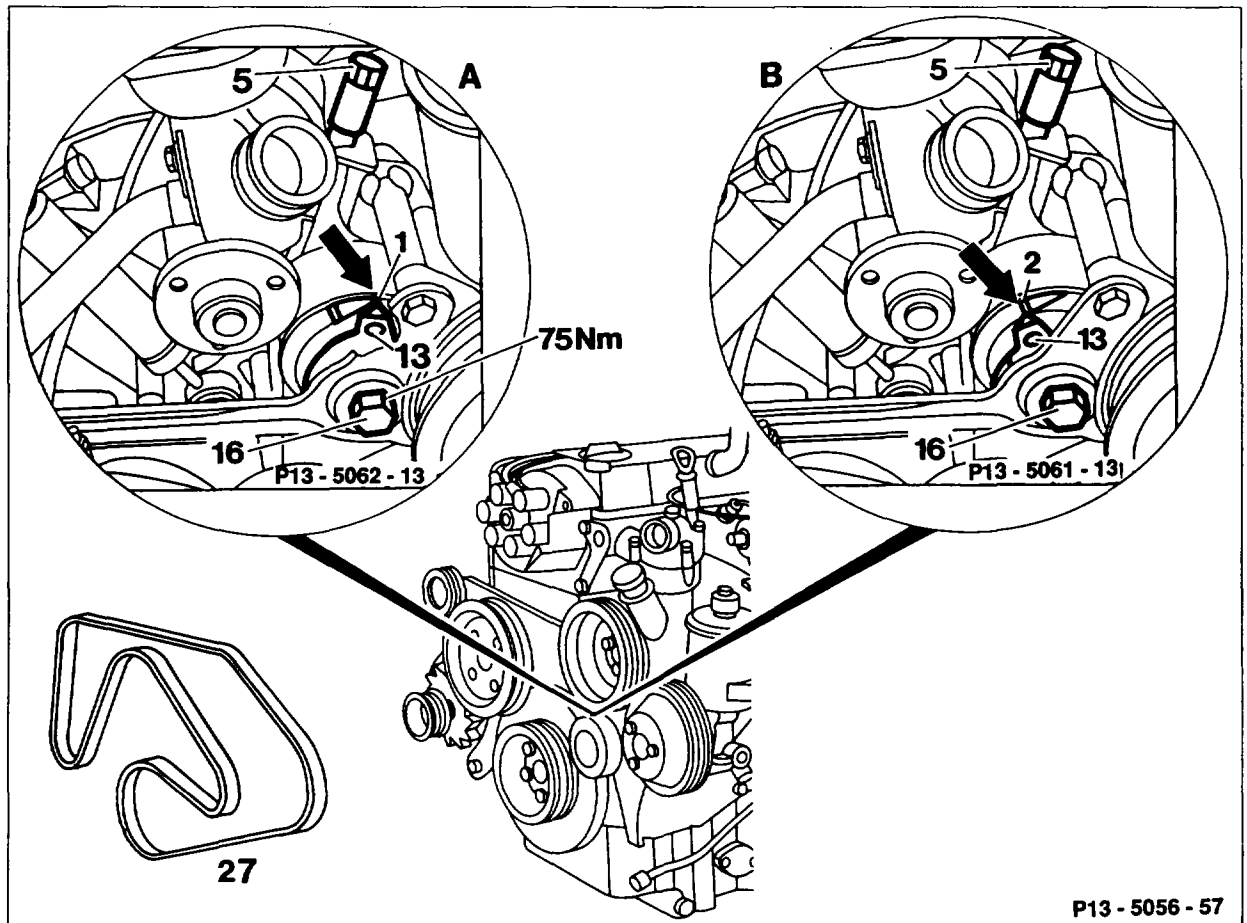

- A Pointer (13) on marking (1) = poly-V-belt slackened
- B Pointer (13) on marking (2) = poly-V-belt tensioned

Bolt (16)	slacken about 1/4 - 1/2 turn.
Tensioning nut (5)	slacken (turn to the left).
Poly-V-belt (27)	take off.
Belt pulley profiles	check for signs of damage and dirt, replace if necessary (eg. worn bearing points of tensioning device, dents in belt pulleys etc.).



If poly-V-belt has broken or dropped off, check concentricity of shafts and belt pulleys.

Setting pointer (13) turn to marking (1) (arrow).

Poly-V-belt	fit on beginning at tensioning pulley (1) (running diagrams, see 13-3440).
Tensioning nut (5)	<p style="text-align: center;">⚠</p> Do not use belt wax or similar products.
Bolt (16)	tension until setting pointer (13) is aligned with marking (2) (arrow). Pay attention to note.
Seat of belt on belt pulleys	tighten (75 Nm). check.

Tightening torque in Nm

Securing bolt of tensioning device

75

Special tool

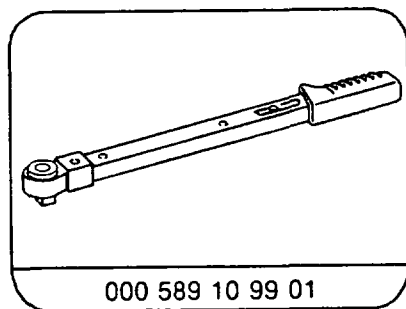

Note

The adhesive plate used (Fig. A) (arrow) has been replaced as of February 1988 by a cast setting scale (Fig. B) (arrow).

On vehicles with adhesive plate (Fig. A) (arrow), tension poly-V-belt as follows.

Turn tensioning nut (5) until setting pointer (13) is matched with the following scale graduations.

Engine w/o A/C compressor	5th graduation
Engine with A/C compressor	7th graduation

