

## 32-0690 Removing and installing electrical control valve (models 201.034/035/036)

Preceding work:

Electrical check valve removed (32-0700).

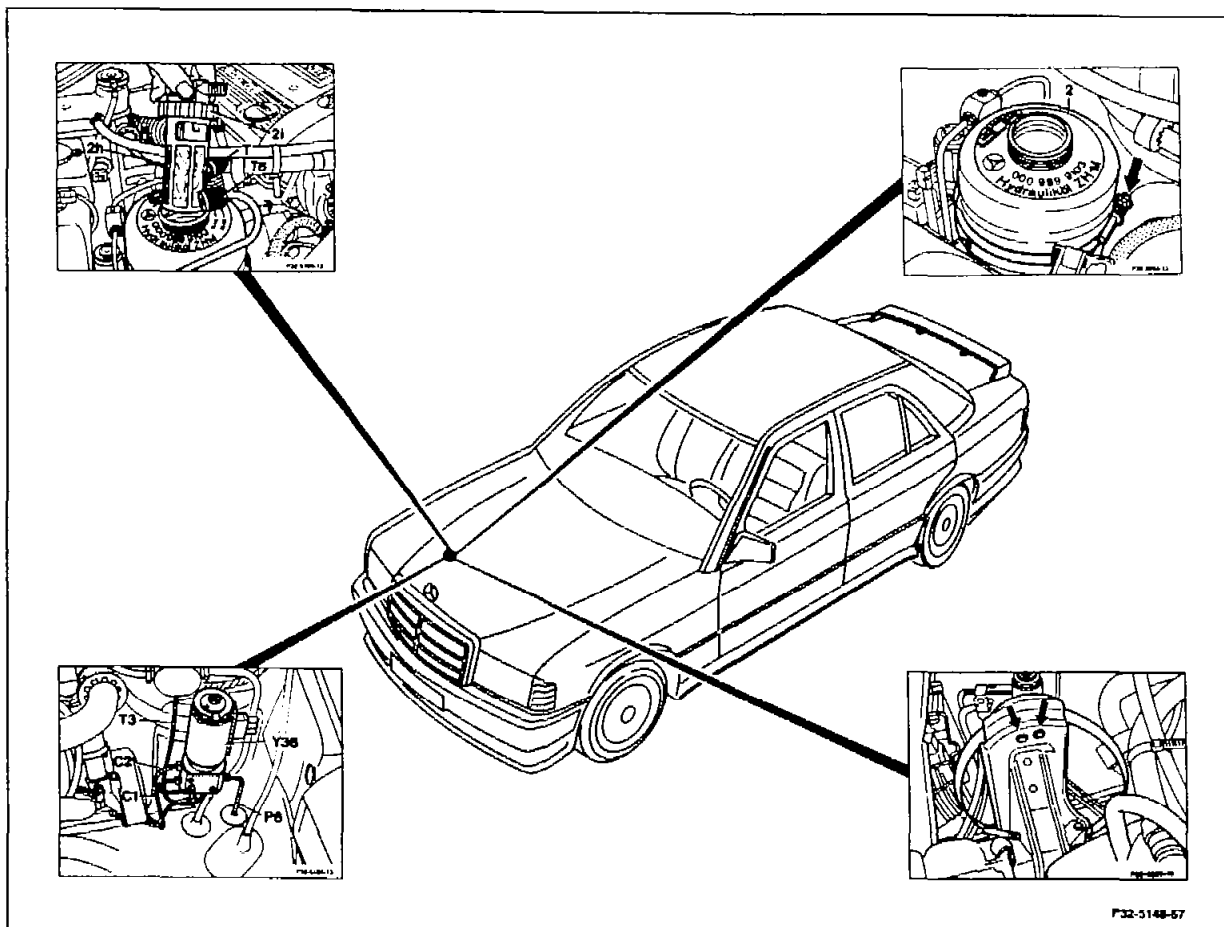

Union nut (2i) .....	Unscrew, tighten.
Oil filter (2h) .....	Remove, install.
Hydraulic oil .....	Draw off using a syringe.
Retaining clamp .....	Release, secure.
Suction line .....	Disconnect, connect.
Oil reservoir (2) .....	Remove, install.
Pressure lines (P6) .....	Disconnect, connect. M10 × 1: 14 Nm, M12 × 1: 20 Nm, M12 × 1.5: 25 Nm.

Control pressure lines (C1 and C2) .....	Disconnect, connect. M10 × 1: 14 Nm, M12 × 1: 20 Nm, M12 × 1.5: 25 Nm.
Return line (T3) .....	Disconnect, connect. M10 × 1: 14 Nm, M12 × 1: 20 Nm, M12 × 1.5: 25 Nm.
3-pin plug .....	Disconnect, connect.
Electrical control valve (Y36) .....	Remove, install.

### Special tools

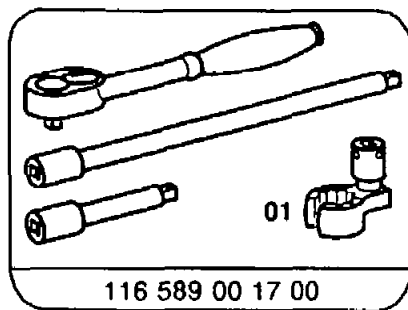

### Commercially available tools

Double-head box wrench 10 × 11 mm	e.g. Messrs. Hazet D-5630 Remscheid
Double-head box wrench 12 × 14 mm	e.g. Messrs. Hazet D-5630 Remscheid

### Removing and installing

- 1 Disconnect return lines (T and T6). Unscrew union nut (2i) and remove with oil filter (2h).
- 2 Extract hydraulic oil from oil reservoir using a syringe.
- 3 Release hose clamp and disconnect suction line.

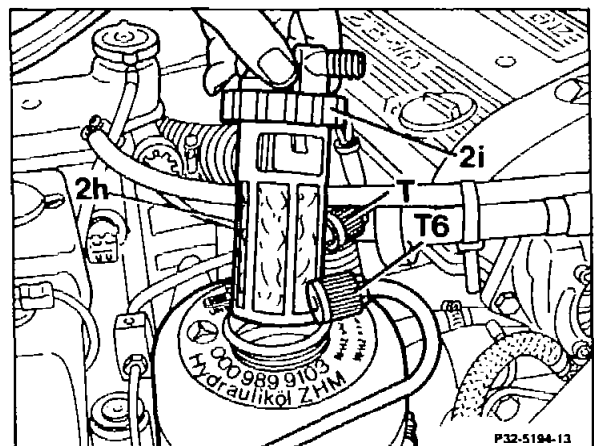

- 4 Release retaining clamp (arrow) and remove oil reservoir (2) upwards.

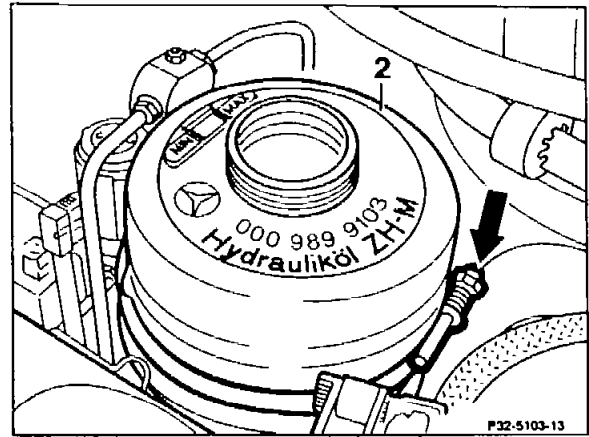

**Control valve version up to 06/88**

- 5 Disconnect lines (P6, C1, C2, T3 and T5) from control valve (Y36).

**Installation notes**

Tightening torques:

M10×1: 14 Nm,

M12×1: 20 Nm,

M12×1.5: 25 Nm.

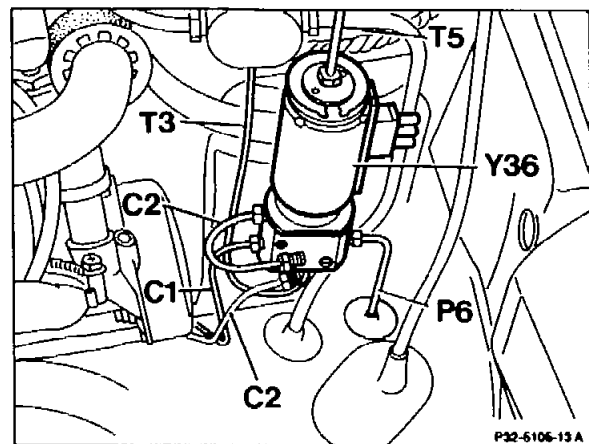

**Control valve version as of 07/88**

- Disconnect lines (P6, C1, C2 and T3) from control valve (Y36).

**Installation notes**

Tightening torques:

M10×1: 14 Nm,

M12×1: 20 Nm,

M12×1.5: 25 Nm.

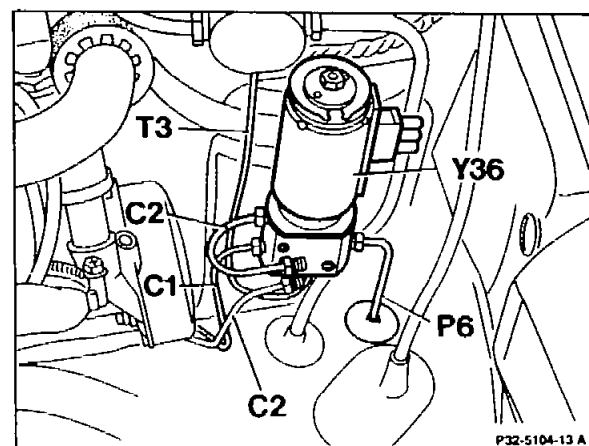

- 6 Unscrew hexagon bolts (arrows) and remove control valve.

- 7 Install in the reverse sequence.

