

42-0228 Checking, removal and installation of brake discs on rear axle

Preceding work:

Remove, mount wheels (40-0016).

Removal of brake pads on rear axle (42-0160)

Operation no. of operation texts and work units or standard texts and flat rates

42-2807, 42-2812

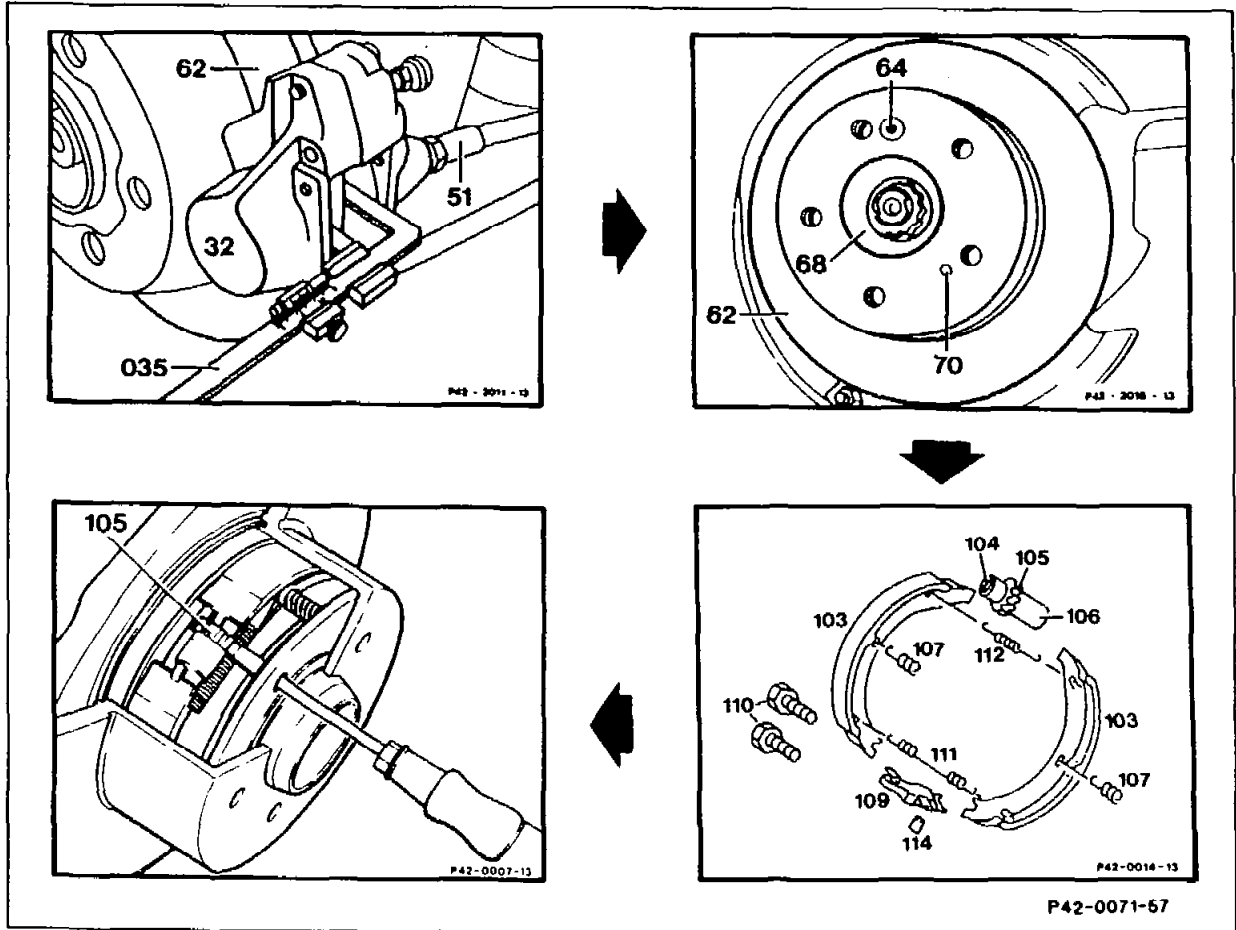

Brake disc (62)

- a) Measure wear in lining opening with vernier gauge (035) 124 589 05 19 00 (see Data). Replace according to condition.
 - b) Inspect visually.
- If the brake discs (62) have large cracks (not measurable), scoremarks deeper than 0.5 mm or have reached the wear limit, replace.

Fixed caliper (32)	remove, install (42-0120). Fasten fixed caliper (32) in wheelhouse with a suitable hook.
	 Do not subject brake hose to tension.
Retaining bolt (64)	Unscrew. Replace. Tightening torque 10 Nm. Torque wrench 001 589 72 21 00.
Brake disc (62)	remove from rear axle shaft flange (68). Loosen tightly seated brake discs (62) from rear axle shaft flange (68) by tapping lightly with a plastic hammer. Ensure that the parking brake is completely released. When installing, the dowel pin (70) must engage properly in the brake disc (62). Observe installation note for brake discs.
Guard	check attachment to wheel carrier.
Rear axle shaft flange (68)	check radial and lateral runout. Use dial gauge holder 363 589 02 21 00 and dial gauge A 1 DIN 878.
Spreader lock (109)	check for easy operation.
Brake shoes for parking brake (103)	check for wear, replace if required (42-0530).
Parking brake	after installing brake disc, adjust at wheel of adjusting device (105) (42-0540).

Data

Model	124.003 124.004 124.007 124.027 124.031 124.032 124.051 124.052 124.06 124.07 124.080 124.081 124.082 124.083 124.088 124.090 124.10 124.127 124.18 124.19 124.29 124.39 201.036	124.008 124.029 124.091 124.092 4)	124.092 5)	124.01 124.020 124.021 124.022 124.023 124.026 124.028 124.030 124.04 124.050 124.120 124.125 124.126 124.128 124.13 124.226 124.230 124.33 201 1)	124.034 124.036 2)	124.036 3)
Brake disc thickness	9	20	10	9	24	22
Limit dimension for maintenance service	7.6	17.7	8.8	7.6	22	20
Wear limit	7.3	17.4	8.3	7.3	21.4	19.4
Brake disc dia.	278 ± 0.4	278 ± 0.4	290 ± 0.4	258 ± 0.4	278 ± 0.4	300 ± 0.4
Inside dia. for parking brake	164 + 0.2	164 + 0.2	164 + 0.2	164 + 0.2	164 + 0.2	164 + 0.2
Lateral runout	max. 0.15	max. 0.15	max. 0.15	max. 0.15	max. 0.15	max. 0.10

1) Not for 201.036.

2) Fitted up to 01/93 and 

3) Fitted as of 02/93 except 

4) Fitted up to 03/95.

5) Fitted as of 04/95.

Note

Brake discs with severe lining deposits on the braking surfaces (visible by grey or blue discoloration of the braking surfaces) must be cleaned before installing new pads (42-260).



If the pedal travel varies during the test drive (primarily after cornering), measure lateral runout of brake disc at outer circumference. For this purpose use dial gauge holder (033) 363 589 02 21 00 and dial gauge A1 DIN 878 (032). If the lateral runout is > 0.15 mm, replace the brake discs.

Always replace both brake discs on **one axle**.

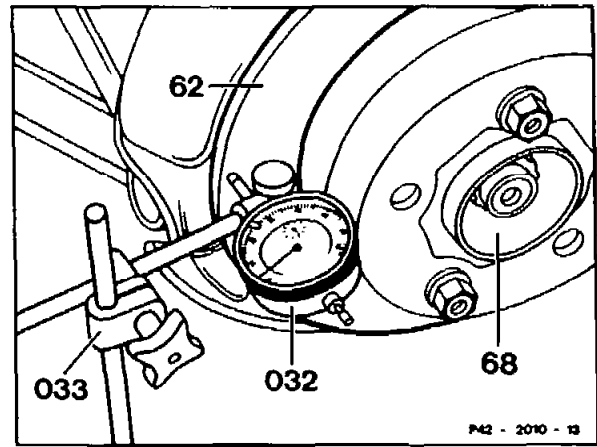

- 62 Brake disc
- 68 Rear axle shaft flange
- 032 Dial gauge
- 033 Dial gauge holder

Installation note on brake disc

Remove any rust on the fitted seat and fitted pin (70) of the rear axle shaft flange with emery cloth and coat with heat-resistance permanent lubricant (Molykote paste "U", Molykote paste G Rapid, Liqui-Moly paste 36) so that brake disc can be removed easily from the rear axle shaft flange later.

Check brake lining surface on parking brake in brake disc drum, clean.

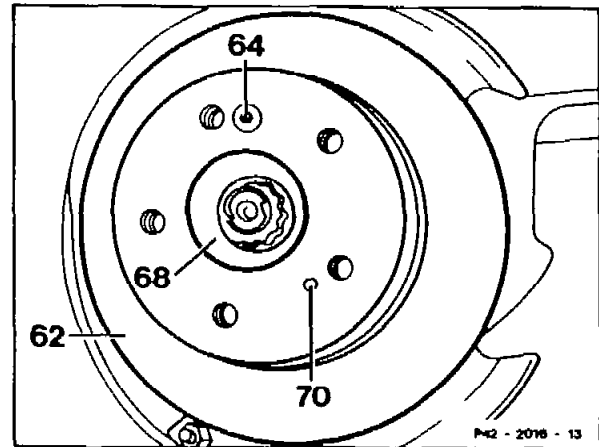

- 62 Brake disc
- 64 Retaining bolt
- 68 Rear axle shaft flange
- 70 Dowel pin

Replacement brake discs are coated with lacquer to protect against corrosion. This protective lacquer (grey varnish) is automatically rubbed off during the first braking maneuvers. The effectiveness of the brakes is not impaired. The following detrimental effects may occur briefly:

- Grating noises during the first braking maneuvers
- Squealing of the unactuated parking brake when the vehicle is moving
- Smell from the brakes during the first severe braking

These disturbances disappear again after a few braking maneuvers (e.g. in the course of the usual brake test on a brake dynamometer which follows replacement of the brake discs).

Special tools

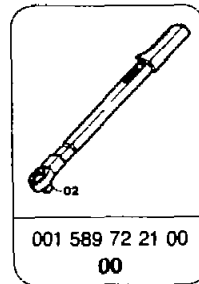
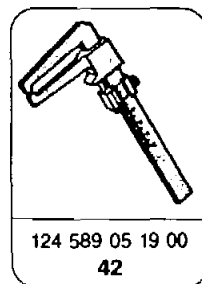
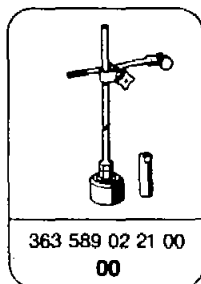

Commercially available tools and testers

Designation	e.g. Messrs., order no.
Dial gauge A 1 DIN 878	Mahr, D-73734 Esslingen Order no. 311 000