

72-050 Removal, installation and adjustment of driver's door

Door lining removed (refer to Note)

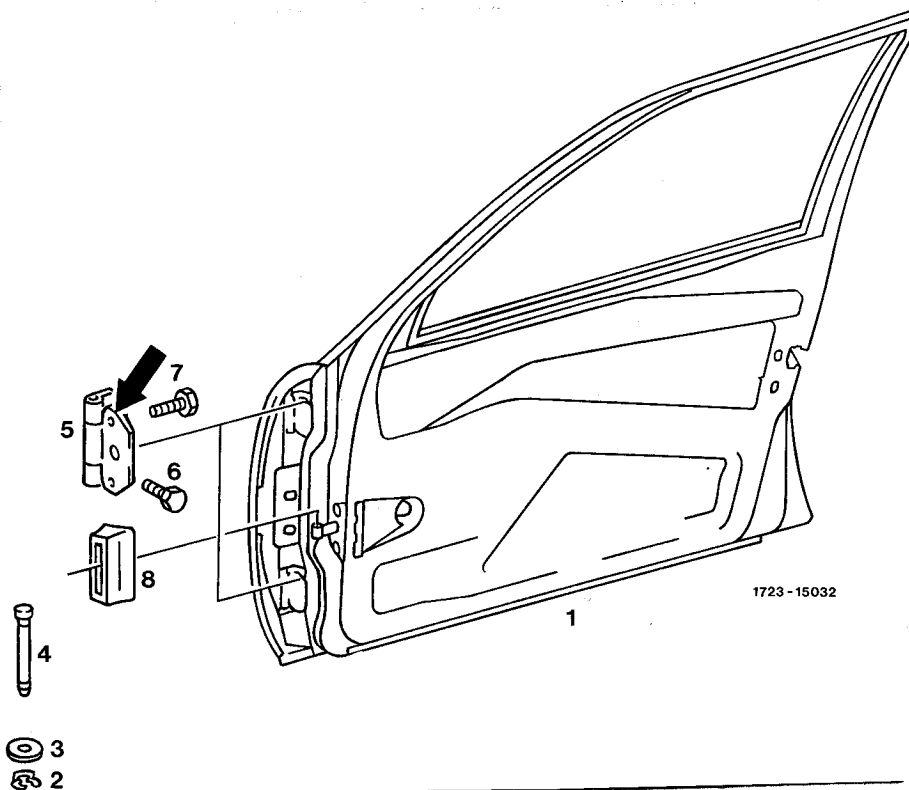

Location of door hinges on contact surface (arrow)	mark to avoid time-consuming door adjustment during re-installation of door
Lock (2) on bolt (4)	remove
Bolt (4)	knock out, special tool 124 589 00 61 00
Plastic washer (3) and rubber rosette (8)	remove
Screws (7) on front wall pillar	(4 each) unscrew, 25 Nm
Door (1)	remove toward the rear

Special tools

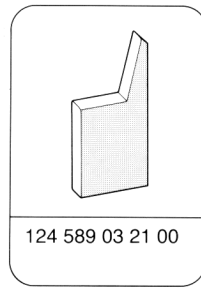
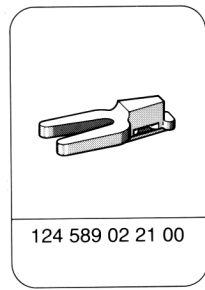
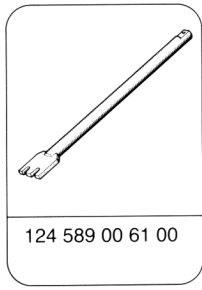

Note

Remove door lining (72-100) on vehicles provided with central locking system, electrically adjustable outside rear view mirror, electrically adjustable front seat, exit lamps or electrical window lift as special equipment. Loosen connections of respective special equipment and pull out through opening on face of inside door plate.

Installation and adjustment

- 1 Position door at markings and slightly tighten fastening screws on hinges.
- 2 Fasten door holder on front wall pillar.



3 Unscrew closing eye.

4 Align driver's door on hinge side in such a manner that the door paneling of the driver's door is flush with contour of front fender or max. 1 mm deeper.

5 Check air gap all-around on door and correct, if required.

Air gap widths (60-070).

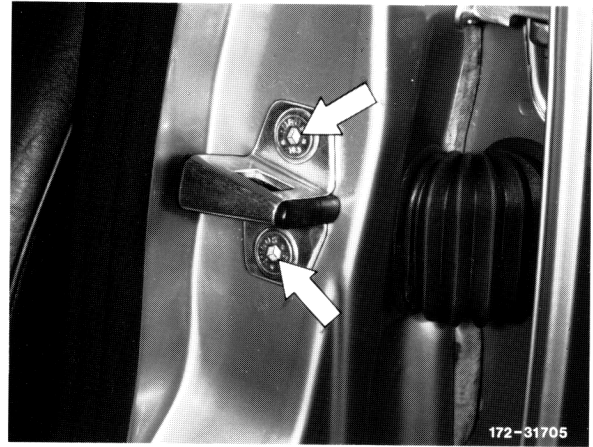

6 Tighten fastening screws on hinges.

7 Check adjustment of rear side door and correct, if required (72-060).

8 Screw on closing eye (do not tighten).

9 Insert centering gauge into door lock until the lock is completely engaged (detent stage 2).

Attention!

The centering gauge is different for lefthand and righthand door lock. Pay attention to mark "L" or "R".



10 Position depth stop at level of closing eye on outside door plate and close door to the extent that the depth stop abuts on both sides.

11 Push closing eye through opened window from inside into centering gauge and tighten fastening screws (17 Nm).

12 Pull outer door handle and remove centering gauge.

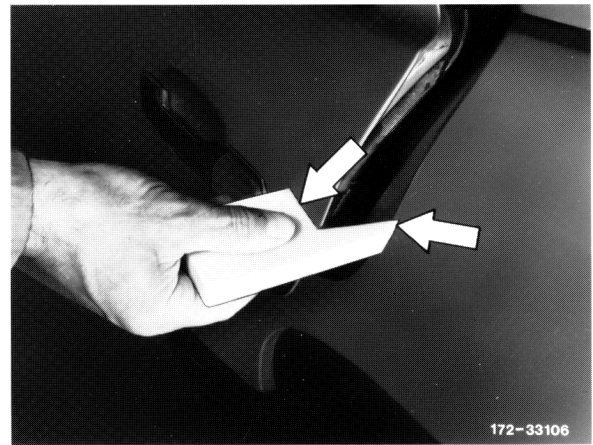

13 Check window frame in ranges A, B and C and straighten, if required.

Note: When straightening window frame, the window must be in its lower position (to avoid breaking window glass). Straighten window frame with care to avoid paint cracks.

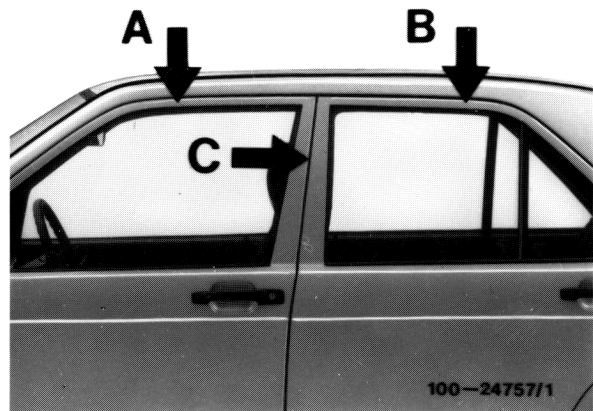

14 Adjust spacing dimensions in range A, B and C.

15 Check door for easy operation.

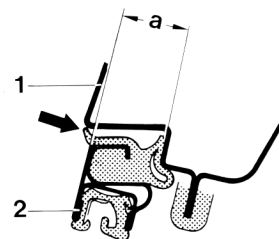

- a 20.5-23 mm
- 1 Roof frame
- 2 Window frame

1724 - 11900/1