

91-125 Removal and installation of gear unit for backrest adjustment

Driver's or front passenger seat removed
(91-100 or 91-110)

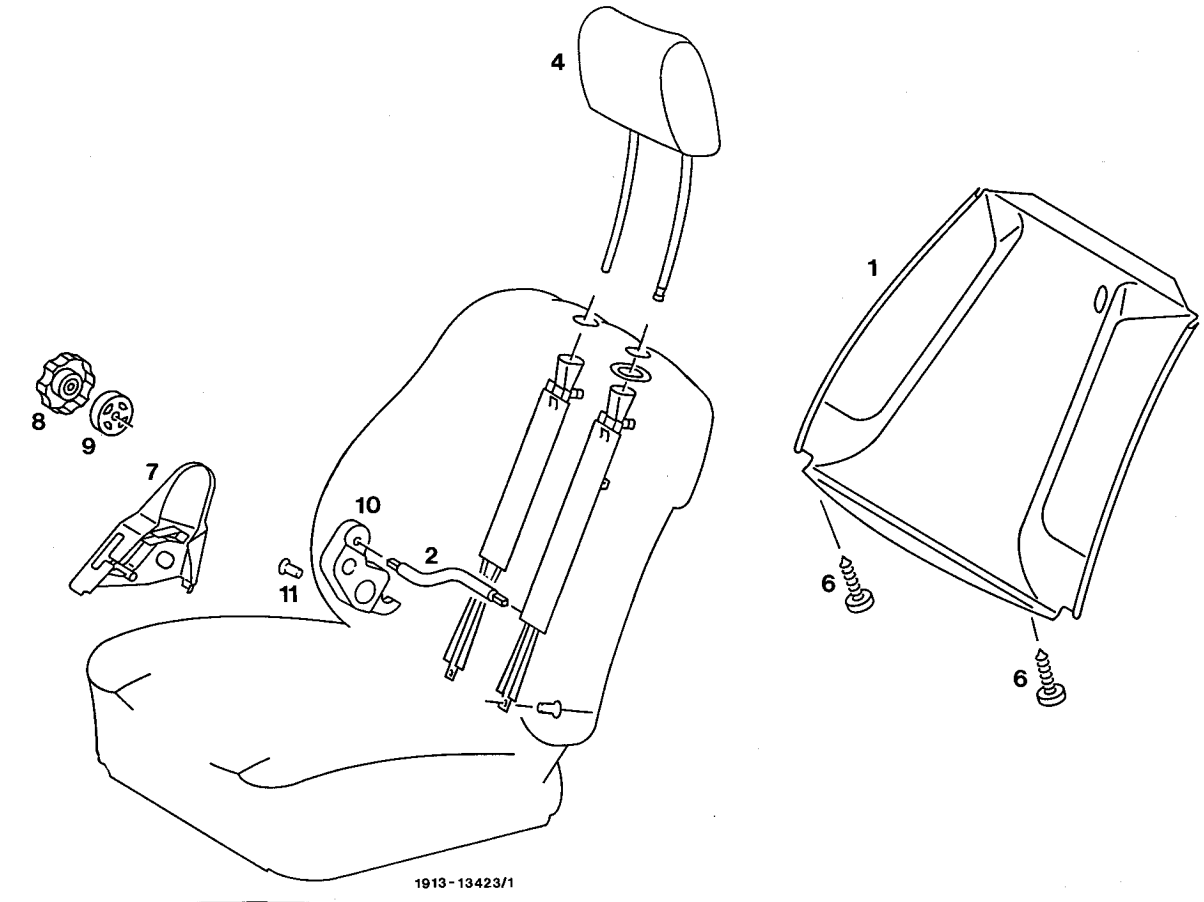

Screw (6)	2 each, unscrew
Clamping member (1)	remove, disengage covering laterally
Flexible shaft (2)	pull out of gears
Trim (7)	force off
Handwheel (8)	force off uniformly
Cover (9)	unbend lock and force off
Gear cover (10)	remove
Rivet 4x6.1 (11)	3 each, bore out
Gears	remove, during installation in backrest frame lock and fasten rivet, part no. 910002 004132

Remove and install

- 1 Remove clamping member (91-190).
- 2 Remove flexible shaft (2) from gears.
- 3 Force off trim (7) with plastic wedge.
- 4 Uniformly force off handwheel (8) by means of 2 plastic wedges.
- 5 Unbend locks on cover (9) and remove from shaft.
- 6 Separate rivet head (3 each) and completely remove gears.



Installation note

Insert gear housing into backrest frame. Make sure that the locking pin is inserted in backrest frame and that the gear housing rests flat against backrest frame.

Fasten gear housing with rivet 4x6.1 (3 each), part no. 910002 004132.

Handwheel (8) and cover (9) must be renewed following disassembly.



- 7 For installation proceed vice versa.